

LEGEND

Existing trees to be retained

Existing trees to be removed

Proposed tree plantings

Proposed shrub plantings

Proposed groundcover plantings

Concrete driveway / path pavement

Non slip tiles pavement

Proposed garden bed

Proposed turf area

Timber garden edge

Unit paver stepping stones

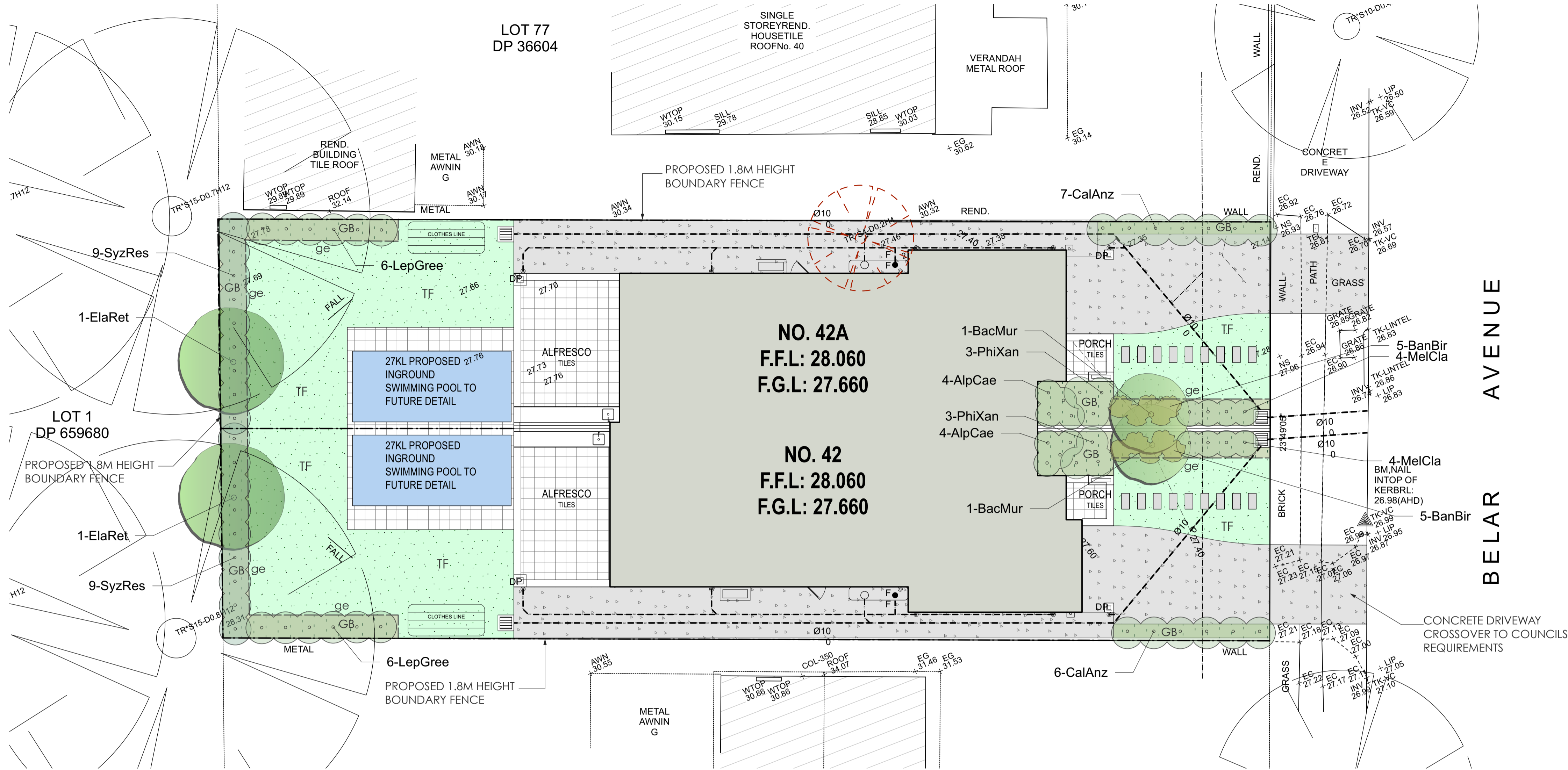

Plant Schedule							
ID	Qty	Common Name	Botanical Name	Size	Mature Height	Mature Spread	Native (N)
Trees							
BacMur	2	Grey Myrtle	Backhousia myrtifolia	45Litre	5 - 10m	3.5 - 6m	N
ElaRet	2	Blueberry Ash	Elaeocarpus reticulatus	45Litre	8 - 10m	3 - 4m	N
Shrubs							
AlpCae	8	Native Ginger	Alpinia caerulea	200mm	0.9 - 1.5m	0.9 - 1.2m	N
CalAnz	13	White Bottle Brush	Callistemon citrinus 'White Anzac'	200mm	0.9 - 1.1m	2.0 - 3.0m	N
LepGree	12	Green Screen Leptospermum	Leptospermum 'Green Screen'	200mm	1.2 - 1.5m	1.2 - 1.5m	N
MelCla	8	Claret Tops Honey Myrtle	Melaleuca 'Claret Tops'	200mm	0.9 - 1.1m	0.6 - 1.0m	N
PhiXan	6	Philodendron	Philodendron xanadu	200mm	0.8 - 1.0m	0.8 - 1.0m	N
SyzRes	18	Resilience Lilly Pilly	Syzygium 'Resilience'	200mm	2 - 3m	1.2 - 2.0m	N
Ground Covers							
BanBir	10	Birthday Candle	Banksia spinulosa 'Birthday Candle'	150mm	0.45 - 0.6m	0.9 - 1.2m	N

GENERAL NOTES:

1. Do not scale of drawings. Follow written dimensions. If in doubt obtain written advice from the Superintendent.

2. Verify all dimensions on site.

3. Refer to legend for all symbol and code keys.

4. Read in conjunction with the specifications

5. Read in conjunction with all associated drawings

A

FOR DA

CL

22.04.25

ISSUE

AMENDMENT

DRAWN

DATE

DESIGNED:

GD

DRAWN:

CL

PREPARED FOR:

MR & MRS KUMAR

PREPARED BY:

Greenland Design Pty Ltd
ABN 73 139 152 855
Registered Landsc. Architect: Bao Ly
Cecil Hills NSW 2171
T: 0403 164 198
E: gd@greenlanddesign.com.au

PROJECT:

PROPOSED DUAL OCCUPANCY

PROJECT ADDRESS:

NO. 42 BELAR AVENUE VILLAWOOD

DRAWING TITLE:

Landscape Plan

DATE:

APRIL 2025

SCALE: 1:200 @ A3
1:100 @ A1

ISSUE:

A

DRAWING NO:

2957.GD.01

0

1

2

5m

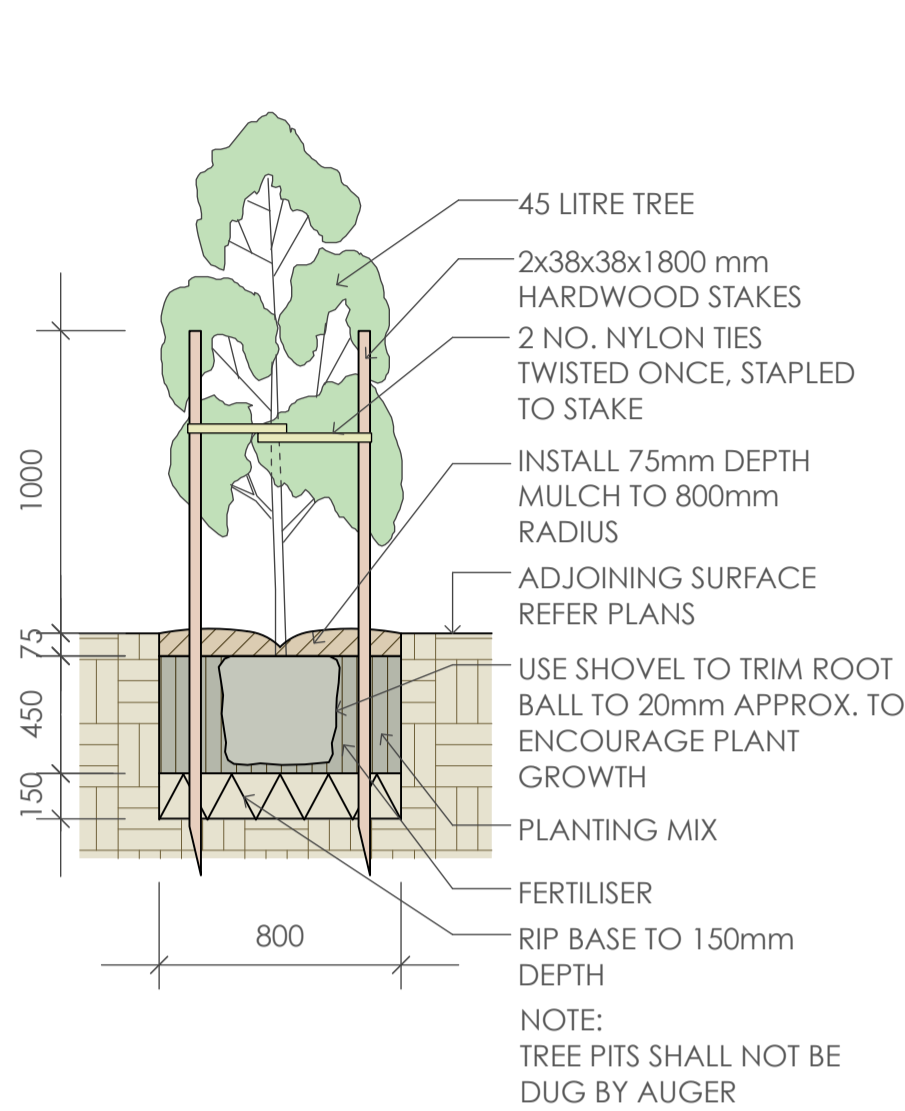

1 45 Litre Tree Planting
scale 1:25

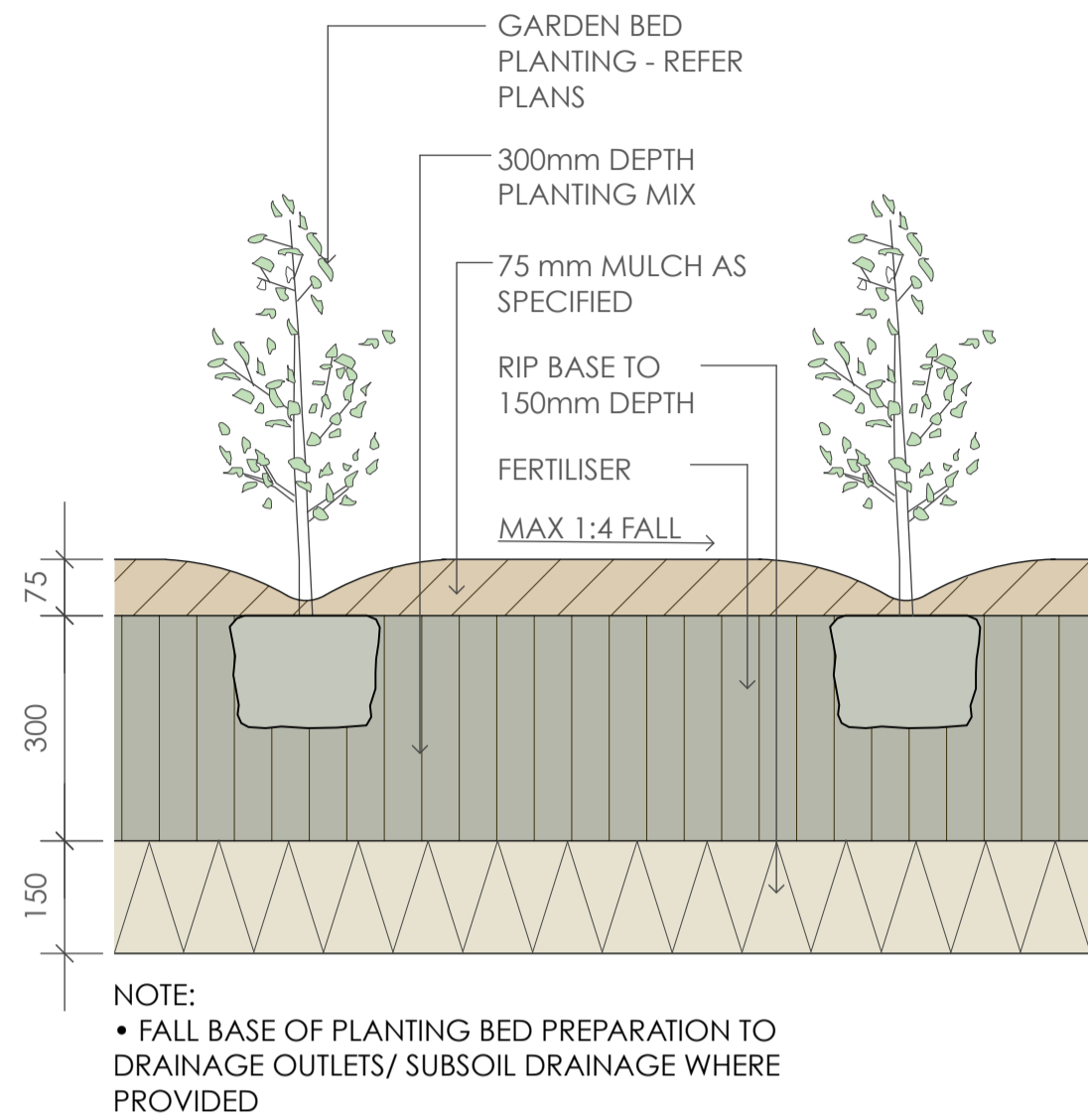

2 Planting Bed Detail
scale 1:10

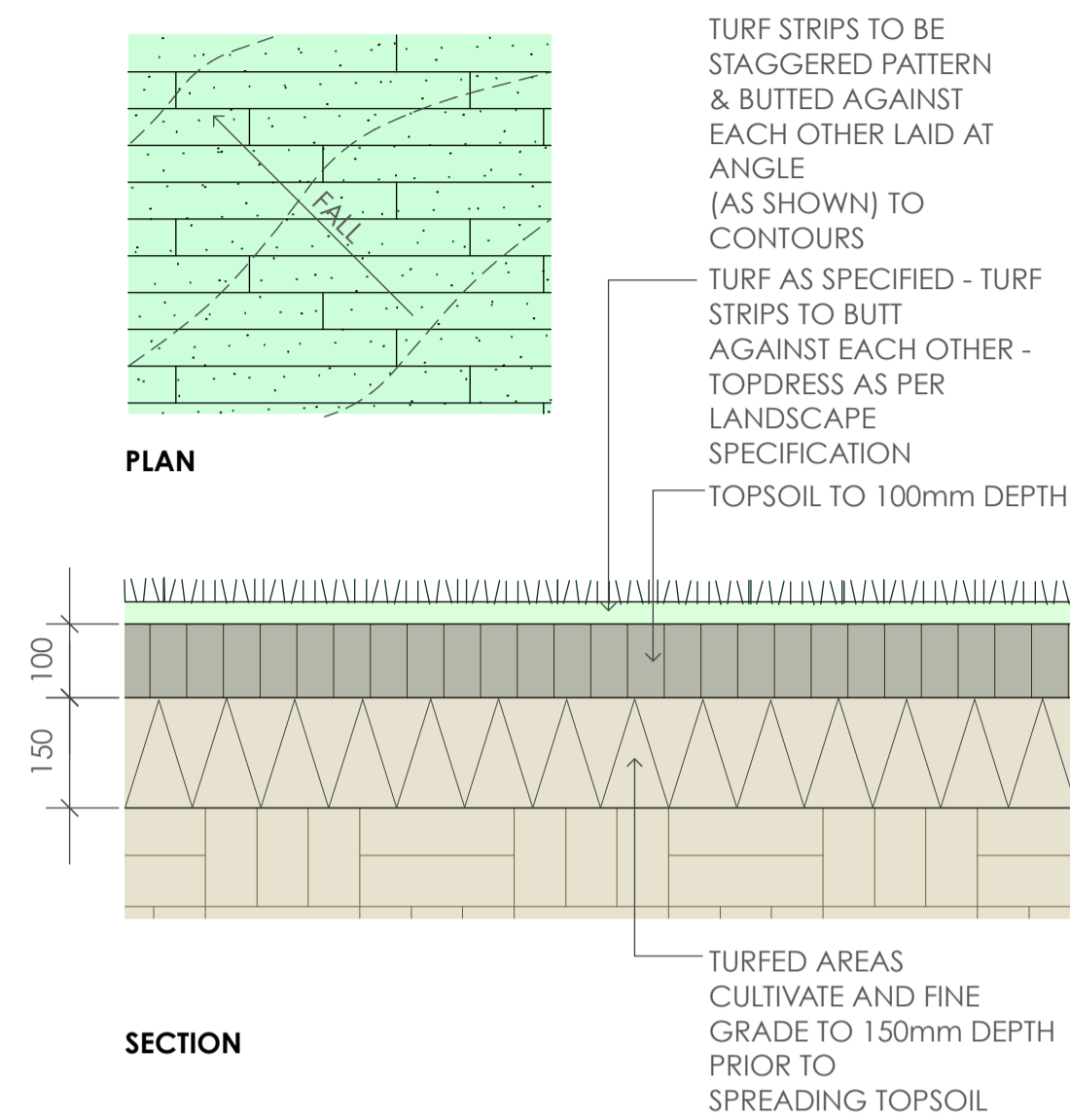

3 Turfing
scale as shown

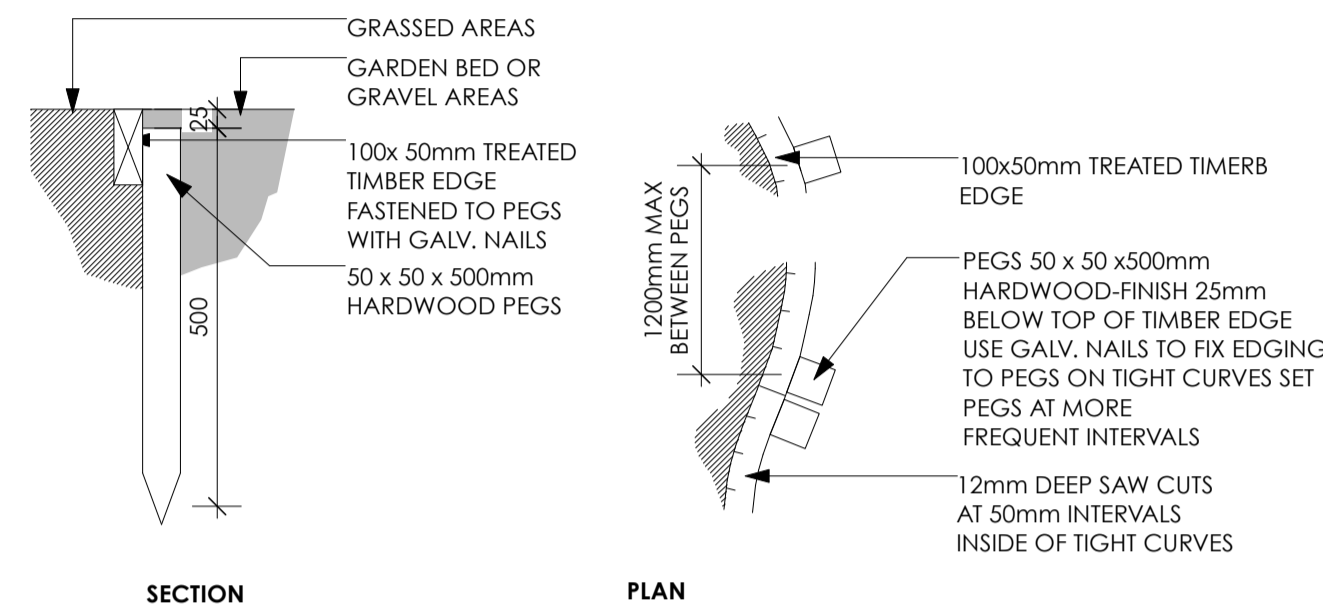

4 Timber Edge
scale 1:10

SPECIFICATION NOTES

PLANTING MATERIALS

Planting Mix:

Planting mix for free pit backfill shall be "Organic Garden Mix" consisting of
50% Black Soil
20% Coarse Sand
30% Organic Material

as available from Australian Native Landscapes, Phone: [02] 9450 1444, or approved equivalent. Samples shall be provided to the Superintendent prior to ordering or delivery to site. Any material delivered to site, that is rejected by the Superintendent, shall be removed by the contractor at his own expense. Minimum depths of mix to all planting bed areas is as specified on details.

Planter Drainage Cell:

Planter drainage cell shall be VersiCell as supplied by Elmich Australia Pty Ltd (ph [02] 9648 2073 or approved equivalent).

Mulch:

Mulch to garden bed:

Mulch shall mean hardwood mulch (25mm grade), free from material derived from Privet, Willow, Poplar, Coral trees, or other noxious weeds. Any mulch exceeding the 25mm grade shall be rejected / removed from the site. Graded hardwood mulch to be supplied by Australian Native Landscapes Pty Ltd Phone [02] 9450 1444, or approved equivalent.

Spread mulch so that after settling, it is:

- smooth and evenly graded between design surface levels;
- flush with adjacent finished levels;
- of the required depths (75mm); and
- sloped towards the base of plant stems in plantation beds, but not in contact with the stem (not closer than 50mm in the case of gravel mulches).

Place after the preparation of the planting bed, planting and all other work.

Plant Material:

All plant material must be true to the species. No substitutes will be allowed. All plants shall be free of fungus and insect damage. All plants shall be healthy, well shaped, not soft or force grown and not root bound.

Plants are available from **Andreasens Green** wholesale nursery, contact Darren [02] 8777 4713, email darren@andreasensgreen.com.au or approved equivalent.

Turfed areas:

All new turfed areas are to be selected weed free Sir Walter DNA Certified Buffalo. Turf shall be laid neatly butted with staggered joins, flush with adjacent surfaces and have even running falls to all drainage points. All new turfed area shall have a minimum 150mm depth of weed free top soil, placed and levelled prior to turfing.

PREPARATION AND HARDWORKS

Excavating for Spot Planting

To planting areas, excavate a hole for each plant large enough to provide not less than twice the depth and twice the diameter than the root ball of species to be planted.

Staking

Use durable hardwood, straight, free from knots or twists, pointed at one end. Drive stakes into the ground a minimum one third of their length, avoiding damage to the root system.

- 45 Litre trees in 2 x 38x38x1800mm Hardwood Stake with double Nylon tie TIES: Provide a 50mm wide Nylon webbing tie per stake, fixed securely to the stakes, one tie at half the height of the main stem and the other as necessary to stabilise the plant.

Timber Edge

MATERIAL: Timber edging shall consist of:

Edging: 100 x 50mm hardwood

Pegs: 50 x 50 x 400mm hardwood.

Fastenings: to be 75x3,75mm diam. galvanised nails

INSTALLATION: Setout alignment of timber edges on site for approval of Superintendent. Excavate to approved alignment and place edge band within trench to confirm peg locations. Install pegs and affix timber edge in accordance with details. All timber edging to finish flush with adjoining turf.

MAINTENANCE / PLANT ESTABLISHMENT

Maintenance shall apply to all hard and soft landscape materials installed prior to the "handover" and acceptance by Principles Representative and the Site Superintendent. The maintenance period shall convenience at the granting of practical completion and shall extend for 12 months.

Maintenance shall consist of the following works:

- Follow a daily watering programme to be approved by Superintendent. Water all plants individually, twice per week or when necessary to ensure constant plant growth. Water all turf and native grassed areas, twice per week.
- Apply appropriate weed control sprays and hand weed as required to maintain planting areas, native grassing bed areas, turfed areas, paved areas, and tree pits in turf free of weed or rogue grass growth.
- Regularly tidy and top up mulch and trim edges to prevent spill over onto paved / grassed areas.
- Spray to control pests and diseases.
- Replace plants, which fail with plants of a similar size and quality as originally specified to approval of Superintendent. Costs of replacement shall be the responsibility of the Contractor. Replacement planting will be undertaken within 2 weeks of identification of dead material or instruction be the Superintendent.
- Report any incidence of plants stolen or destroyed by vandalism.
- Adjust stakes and ties to plants as necessary. Ensure that strangulation of plants does not occur.
- Prune and shape plants as directed or where necessary.
- Make good any defects or faults arising out of defective workmanship or materials.
- Fertilise lawn areas to maintain healthy growth.
- Make good any erosion or soil subsidence, which may occur including soft areas in pathways.
- Mow lawn to maintain neat healthy growth.
- A final inspection shall be made by the Superintendent before handover. Any items requiring rectification shall be repaired before the works are finally approved, and retention moneys released.

NOTE:

- All finished levels are to be verified by Contractor on site.
- All landscape works be in strict accordance with Council's landscape code and guidelines
- This plan to be used in conjunction with all other submitted architectural, hydraulics and engineering drawing where applicable.

GENERAL NOTES: 1. Do not scale of drawings. Follow written dimensions. If in doubt obtain written advice from the Superintendent. 2. Verify all dimensions on site. 3. Refer to legend for all symbol and code keys. 4. Read in conjunction with the specifications 5. Read in conjunction with all associated drawings	A	FOR DA	CL	22.04.25	DESIGNED: GD	PREPARED FOR: MR & MRS KUMAR	PREPARED BY:  Greenland Design Pty Ltd ABN 73 139 152 855 Registered Landscape Architect: Bao Ly Cecil Hills NSW 2171 T: 0403 164 198 E: gd@greenlanddesign.com.au	PROJECT: PROPOSED DUAL OCCUPANCY	DRAWING TITLE: Landscape Details & Specification	DATE: APRIL 2025	
					DRAWN: CL					SCALE: varies	ISSUE: A
					ISSUE	AMENDMENT	DRAWN	DATE	DRAWING NO: 2957.GD.02		